

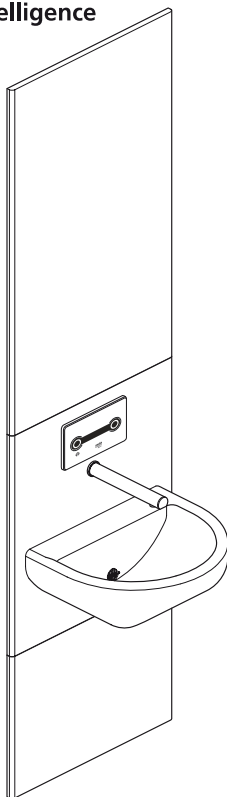

## Rada Acu-T3 Digital Mixing Valve



T-logic™ Digital Intelligence



### INSTALLATION MANUAL

#### **IMPORTANT**

**Installer:** These instructions are for the installation of the Rada Acu to IPS panels only. For details of post panel installation, commissioning, operation and maintenance refer to the Rada Acu Product Manual.

# PANEL DIMENSIONS

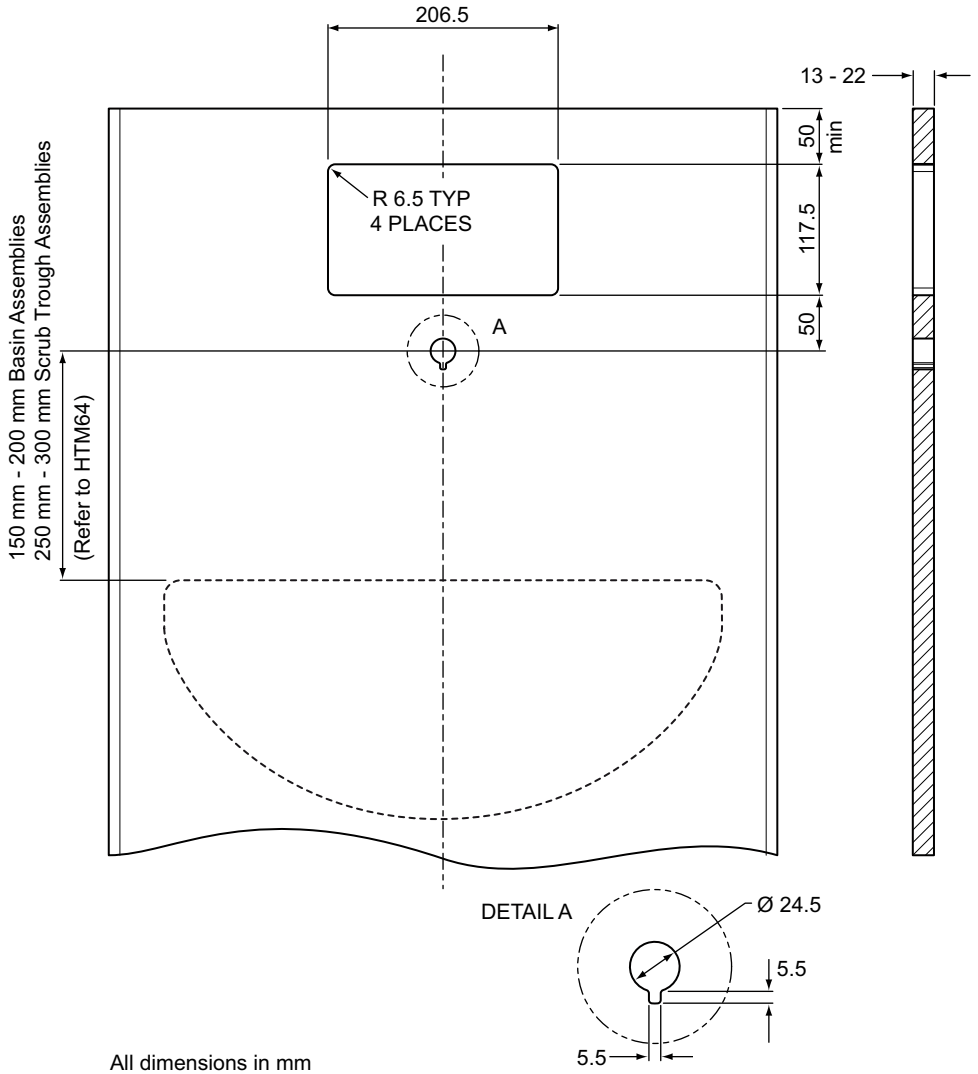

## PACK CONTENTS

Tick the appropriate boxes to familiarise yourself with the part names and to confirm that the parts are included.

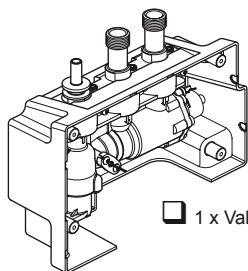

☐ 1 x Valve Assembly

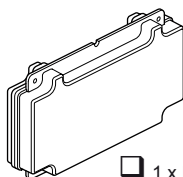

☐ 1 x PCB Box Assembly

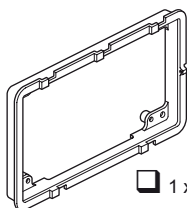

☐ 1 x Mounting Frame

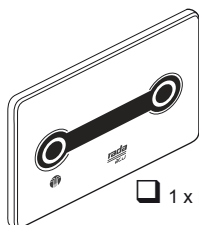

☐ 1 x Fascia

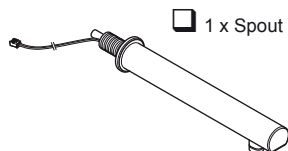

☐ 1 x Spout

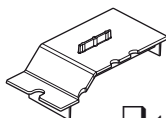

☐ 1 x Access Door

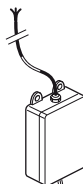

☐ 1 x PSU

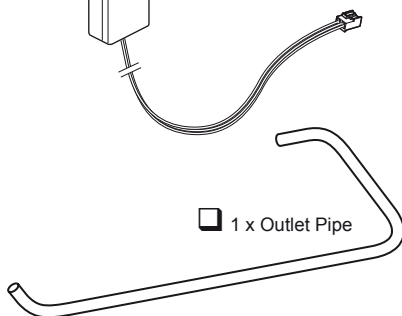

☐ 1 x Outlet Pipe

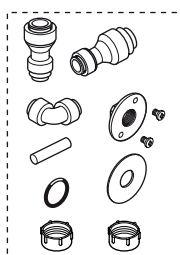

- ☐ 2 x Push Fit Reducers
- ☐ 1 x Push Fit Elbow
- ☐ 1 x Short Outlet Pipe
- ☐ 1 x 'O' Seal
- ☐ 1 x Spout Retaining Nut
- ☐ 1 x Rubber Washer
- ☐ 2 x Inlet Blanking Caps
- ☐ 2 x Earthing Screws

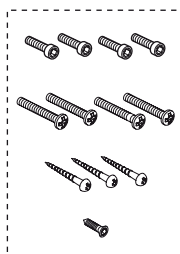

- ☐ 4 x PCB Box Screws
- ☐ 4 x Valve Assembly Screws
- ☐ 3 x PSU Screws
- ☐ 1 x Fascia Screw



☐ 1 x Commissioning Pack

## INSTALLATION

**Important!** These instructions are for the installation of the Rada Acu to IPS panels only. For details of post panel installation, commissioning, operation and maintenance refer to the Rada Acu Product Manual.

Installation must be carried out in accordance with these instructions, and must be conducted by designated, qualified and competent personnel.

### Prepare the Panel

The panel must be cut in accordance with the dimensions shown in this guide, and the basin installation carried out in accordance with manufacturers instructions.

### Step 1. Install the PSU

1.1 Using the PSU as a guide, mark the fixing hole positions on the rear of the panel.

**Note!** To aid servicing, it is recommended that the PSU is fitted to the rear of the panel close to the valve box (refer to illustration).

1.2 Drill the holes using a suitable drill.

**Caution! Take into account the panel thickness (minimum 13 mm), take care not to drill through the panel.**

1.3 Secure the PSU to the panel frame using the 3 PSU screws supplied.

**Important! The PSU must be installed vertically, as illustrated.**

**Caution! Make sure that you use the correct screws (supplied) so as not to screw through the panel, minimum panel thickness 13 mm.**

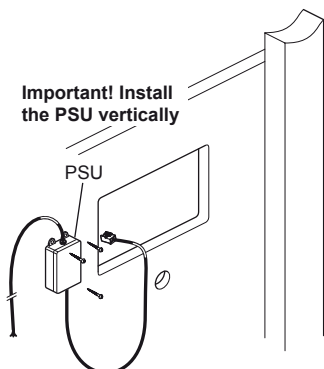

### Step 2. Install the Spout Assembly

2.1 Feed the outlet pipe, sensor cable and spout inlet through the panel.

**Note!** Align the spout inlet with the notch in the panel.

**Important!** Make sure that the 'O' Seal is fitted.

2.2 Fit the two earthing screws into the holes in the nut flange.

2.3 Make sure that the rubber washer is fitted and tighten the nut with a suitable spanner.

**Caution!** Do not overtighten.

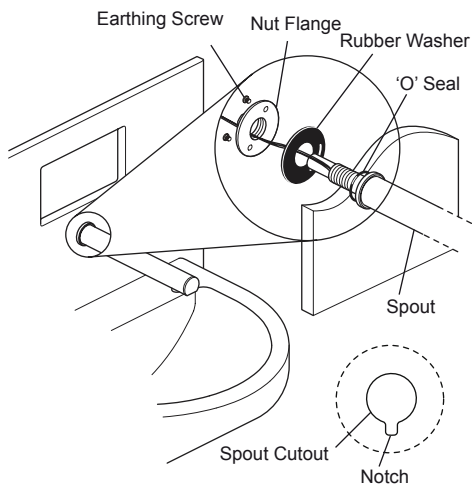

### Step 3. Install the Valve Assembly

**3.1** Fit the mounting frame into the rectangular cutout in the panel with the 3 locators at the top, and secure to the valve assembly with the 4 valve assembly screws (supplied).

**Important!** Feed the PSU and sensor cables back through the panel and mounting frame, making sure that they are aligned with the cutouts in the access door.

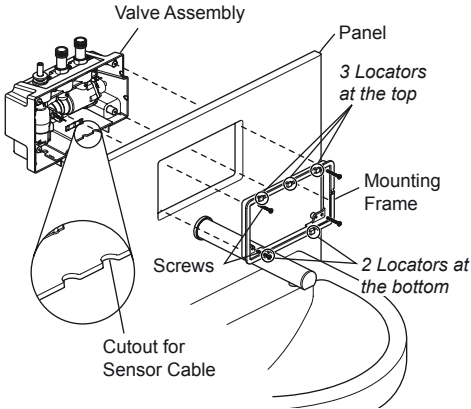

**3.2** Using a 3 mm hexagonal key or a flat faced screwdriver open the 1/4 turn isolating valves.

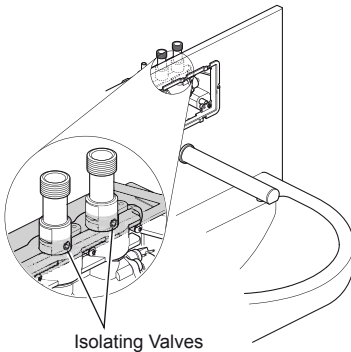

**3.3** Slide and lift the PCB box assembly door to reveal the PCB connector ports.

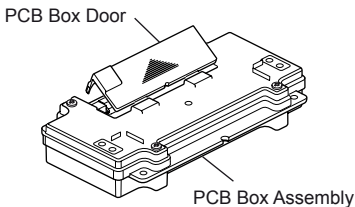

**3.4** Make the connections to the PCB from the PSU, solenoid, spout sensor, thermistor and stepper motor.

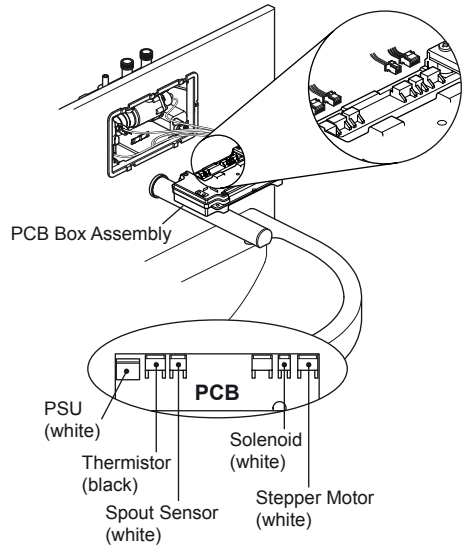

**3.5** Close the PCB box assembly door and carefully secure the PCB box assembly to the mounting frame with the 4 PCB box screws (supplied) using a 3 mm hexagonal key.

**Caution!** Make sure that the wires do not become trapped.

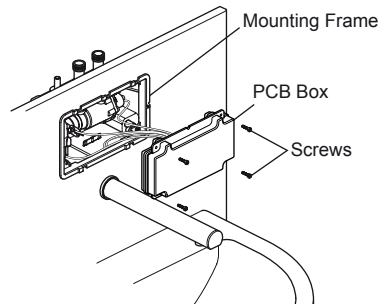

- 3.6 Using the push fit reducers, push fit elbow, hose and outlet pipe (supplied) make the connections between the valve outlet and the spout inlet.

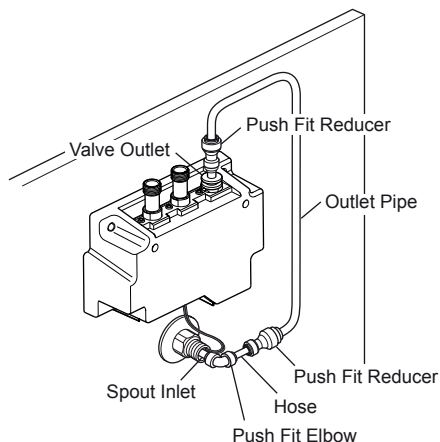

- 3.7 Slide the fascia over the mounting frame and secure by tightening the screw with a 2 mm hexagonal key.

**Important!** Do not remove the protective film from the fascia.

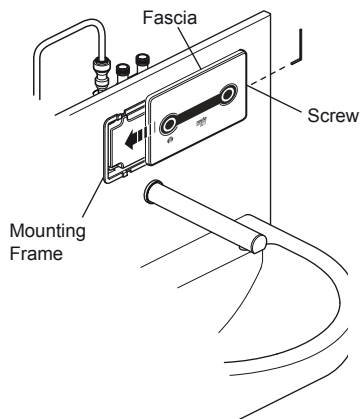

## Step 4. Test the Rada Acu

- 4.1 Connect the electrical and water supplies to the digital mixing valve.

- 4.2 With the power and water supplies turned on, operate the valve and check for leaks, paying particular attention to the push fit connections at the rear of the panel and the spout joint through the panel.

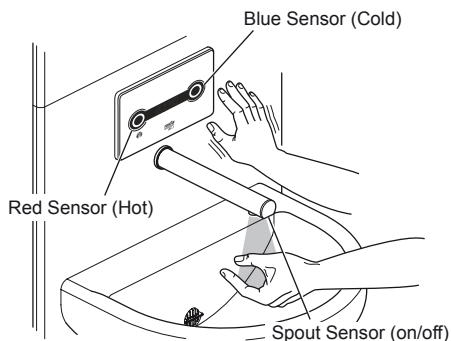

- 4.3 Isolate the water supplies, remove the connections and operate the valve to drain any residual water.

- 4.4 Re-open isolating valves and re-attach blanking caps.

- 4.5 Isolate the power supply and remove the connections.

- 4.6 Secure the commissioning pack to the panel.

- 4.7 This completes the installation of the Rada Acu. For commissioning, operation and maintenance instructions refer to the Rada Acu Product Manual.



## CUSTOMER CARE

Your product has the benefit of our manufacturer's guarantee which commences from date of purchase or from the date of commissioning when product commissioning has been conducted by the UK Rada Commercial Field Team (available UK Only).

Please visit **[www.radacontrols.com](http://www.radacontrols.com)** or contact your local agent for all terms and conditions including details of the Rada commissioning service for the UK

### **UK Customer Service & Post Installation enquiries**

0844 571 1777

Fax: 01242 282595

Email: [radacustomerservices@mirashowers.com](mailto:radacustomerservices@mirashowers.com)

### **Pre-Specification Enquiries**

0844 571 1777

Fax: 01242 282404

**E-mail:** [rada\\_technical@mirashowers.com](mailto:rada_technical@mirashowers.com)

**By Post:** Rada Controls, Cromwell Road, Cheltenham, Gloucestershire GL52 5EP

**To Contact Us:** Eire Only

**Telephone:** 01 531 9337

**E Mail:** [CustomerServiceEire@mirashowers.com](mailto:CustomerServiceEire@mirashowers.com)