



ACCESSORIES

**Mira Shower Seat,
Part No. 2.1536.129 White/Chrome
2.1536.128 White**

A white folding shower seat for mounting inside the bathroom or shower area, particularly suitable for the elderly or infirm. Manufactured from ABS engineering plastic with slip resistant finish with stainless steel hinge pins. Weight capacity: 95.5kg evenly distributed.



Dimensions (All dimensions in mm)
Mira Shower Seat

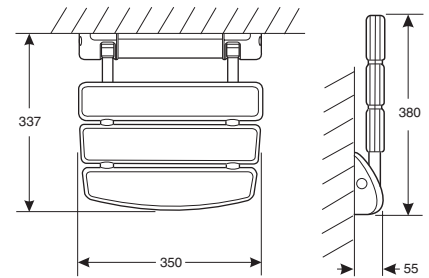

**AD13 Cranked Tube,
Part No. 5.101.59.1.0**

Designed to connect the Rada TF503 to the Rada 215. Can be cut to length on site for compression connection direct to mixing valve.

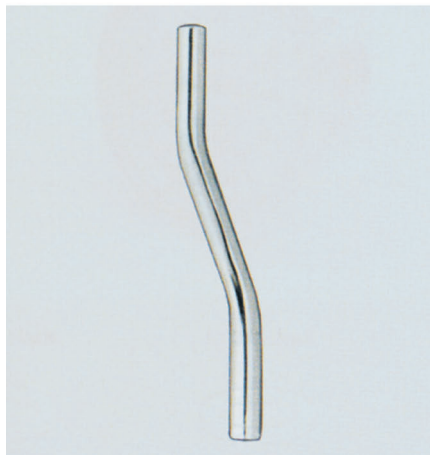

Rada AD13

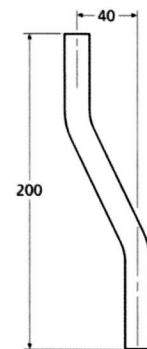

**DV15 15mm Automatic Drain
Valve, Part No. 1.0.109.01.2**

Designed to automatically drain the water from a shower fitting when the shower control is turned off. Its purpose is to remove the residual water which, when present, can support microbiological and bacteriological growth.



Rada DV15

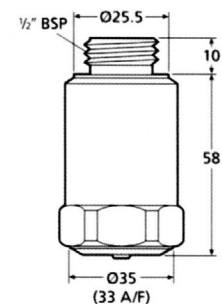

**DV1015 chrome plated 'Tee'
and Adaptor,
Part No. 1.0.109.10.2**

Connects the DV15 automatic drain valve to the AD29 hose and AD10 connector.

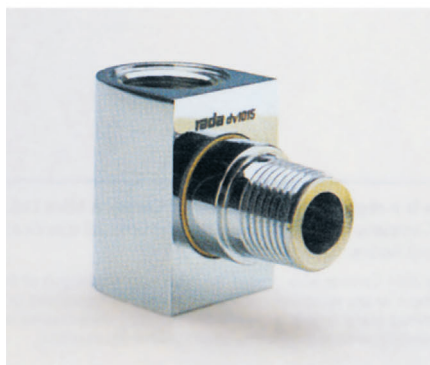

Rada DV1015

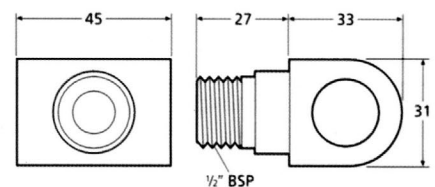

**AD10 Connector,
Part No. 1.0.095.06.1**

90° adaptor to connect flexible hose, DV1015 Tee piece or DV15 automatic drain valve to concealed pipework. Solid chrome plated brass body, supplied with 1/2" BSP male threaded inlet tube which may be cut to length and 1/2" BSP male outlet nipple.

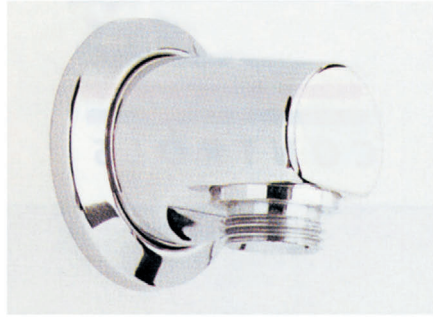

Rada AD10

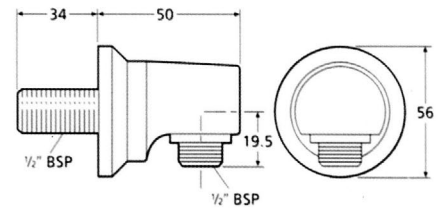

**CV1015 Isolating Check Valve,
Part No. 1.0.110.58.1**

A 1/2" inlet check valve incorporating both isolating ball valve and strainer in one unit.

Designed to meet water bye-law requirements to prevent backflow of water from the inlets of any mixing device such as mixing taps and shower mixing valves.

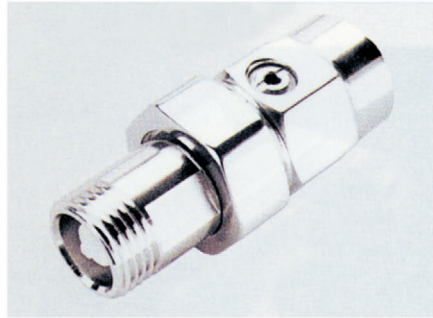

Rada CV1015

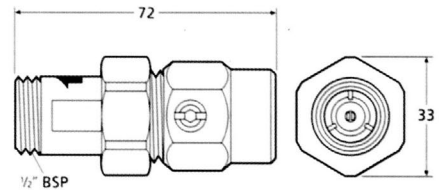

TH101/TH102 Thermometers

A range of dial thermometers for accurate indication of water temperature. An adaptor with 3/4" male taper thread enables the thermometer to be viewed correctly when connected to the appropriate tee.

Rada TH101, Part No. 3.1.128.09.1
65mm thermometer (0–100°C).

Rada TH102, Part No. 3.1.128.06.1
100mm thermometer (0–120°C).



Rada TH101/TH102

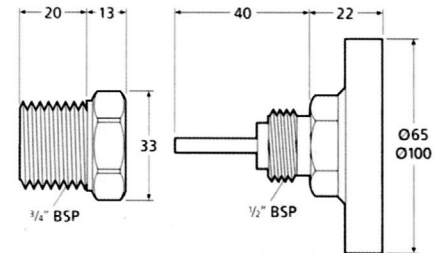

AD14/AD15/AD17 Adaptors

AD14, Part No. 5.555.39.1.0

3/4" male BSP to 1/2" male BSP adaptor.

AD15, Part No. 5.555.08.1.0

3/4" female BSP to 1/2" male BSP adaptor.

AD17, Part No. 5.555.40.1.0

3/4" female BSP to 15mm male compression.

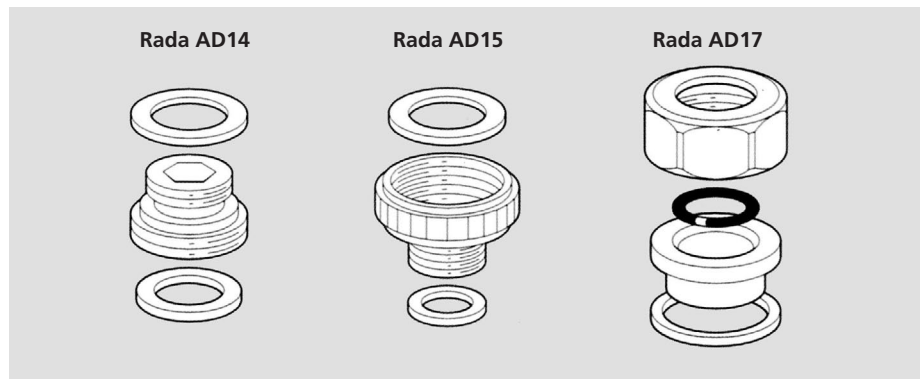

SPECIFICATION ENQUIRIES

Tel: 01242 282527 Fax: 01242 282404

e-mail: Rada_Technical@mirashowers.com

Web: www.radacontrols.com

Kohler Mira Limited

Cromwell Road, Cheltenham,
Gloucestershire, GL52 5EP, UK

Tel: +44 (0) 1242 221221 Fax: +44 (0) 1242 224721

Rada is a registered trade mark of Kohler Mira Limited.

The Company reserves the right to alter product specification without notice.

© May 2003 Kohler Mira Limited. All rights reserved. No part of this document, or any accompanying document, may be reproduced or transmitted in any form or by any means, including photocopying or electronically, without the permission of Kohler Mira Limited.

A **KOHLER** COMPANY



FM 14648

